

CRESCENT KEEL

AT WATERSOUND® BEACH



WATER·SOUND®



BEACH

SEA WATCH

CRESCENT KEEL AT WATERSOUND BEACH - SEA WATCH

ROOM DIMENSIONS

6 BEDROOMS - 6 1/2 BATHS - POOL

master bedroom.....	21'-0" x 19'-4"
bedroom #1.....	13'-8" x 16'-4"
bedroom #2.....	14'-5" x 12'-6"
bedroom #3.....	15'-2" x 8'-3"
bedroom #4.....	10'-5" x 14'-0"
guest bedroom.....	13'-8" x 10'-5"
bunk room.....	12'-8" x 14'-8"
great room.....	18'-0" x 16'-0"
dining room.....	18'-0" x 13'-6"

DUNE CONSTRUCTION

SQUARE FOOTAGE

conditioned - 4,937
 porches - 1,006
 garage - 286
 carriage house - 430

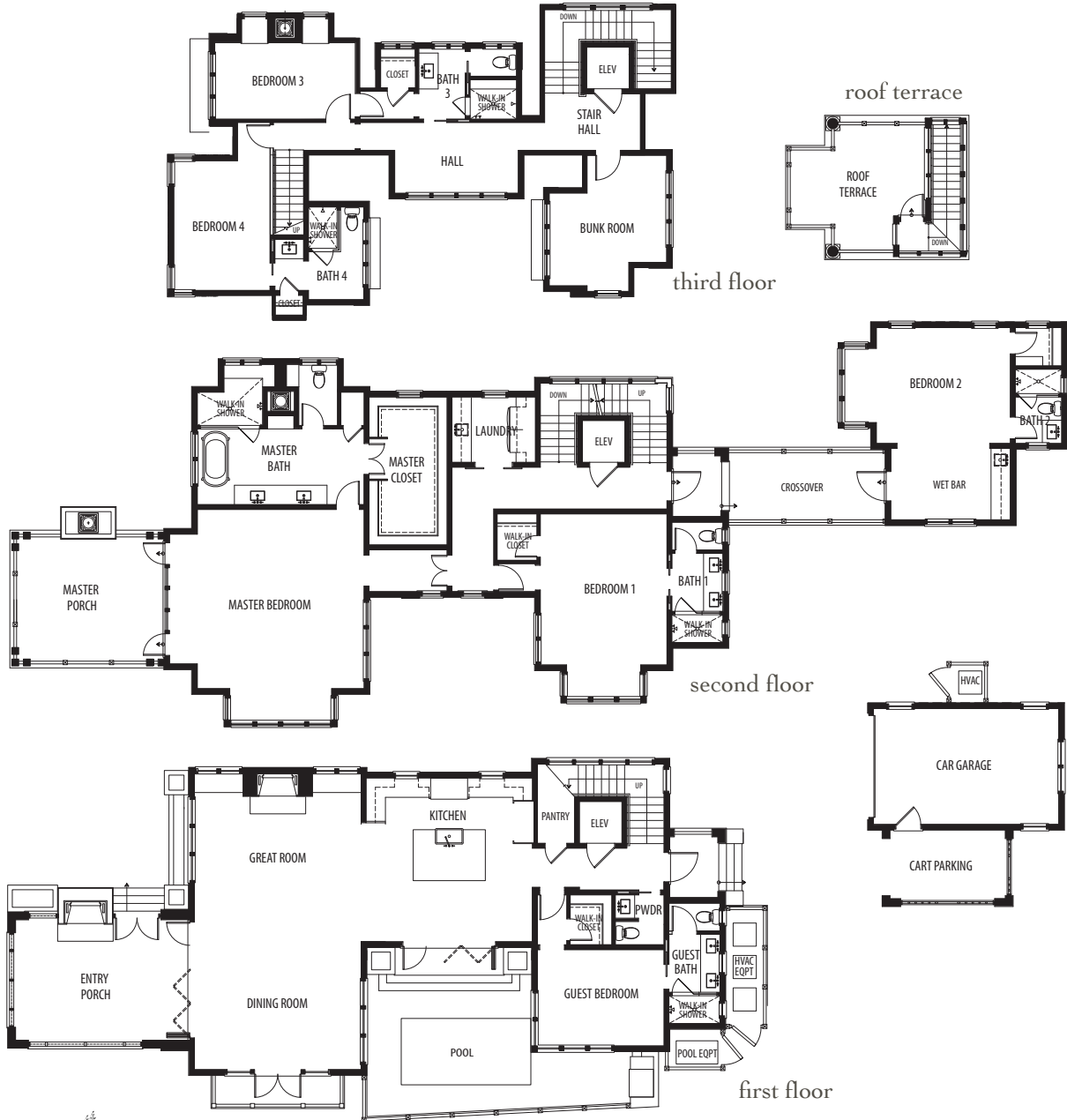

© The St. Joe Company 2017 All Rights Reserved. "JOE", "St. Joe", "St. Joe (and the Taking Flight design)", the "Taking Flight" design, "WaterSound" and the "WaterSound (and boat design)" are registered service marks of The St. Joe Company or its affiliates. The materials and features and amenities described and depicted herein are based upon current development plans, which are subject to change without notice. WaterSound Beach Club, Camp Creek Golf Club, and Shark's Tooth Golf Club are private clubs for St. Joe designated communities which require purchase of separate memberships subject to application and acceptance and may be subject to payment of fees, membership requirements, rules or other limitations which are subject to change. This does not constitute an offer to sell real property in any jurisdiction where prior registration or other advance qualifications of real property is required, including New York. Square footages and room dimensions are approximations. Void where prohibited by law. Equal Housing Opportunity. Dune Construction & Development, LLC, is independently owned and operated and is not an affiliate of The St. Joe Company. The St. Joe Company does not guarantee the obligations of, nor provide any warranties for, unaffiliated or third-party builders who build homes in the WaterSound Beach community. Illustrations are artist's depictions only and may differ from completed improvements. Obtain the Property Report required by Federal Law and read it before signing anything. No Federal agency has judged the merits or value, if any of this property.

